



KRAMER

CON-FIELD

CAT6A RJ45 Field plug

AWG 26/1 - 22/1, AWG 27/7 - 22/7

899351-05

Mounting note for the installer



i NOTE

Avoid connection errors!
Read installation instructions carefully before connecting!

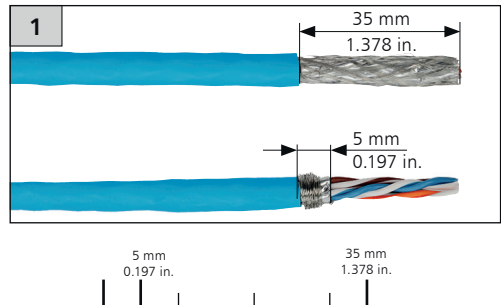
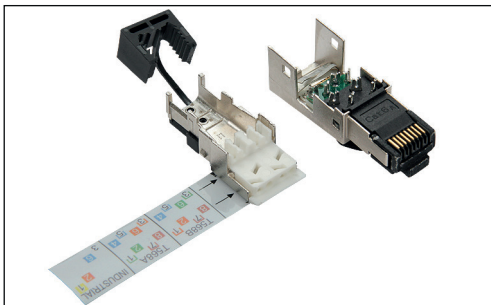

2 PIN assignments			
PIN Nr. / No. / contact no.	T568A	T568B	INDUSTRIAL (Profinet)
1	WH-GN	WH-OG	YE
2	GN	OG	OG
3	WH-OG	WH-GN	WH
4	BU	BU	-
5	WH-BU	WH-BU	-
6	OG	GN	BU
7	WH-BN	WH-BN	-
8	BN	BN	-

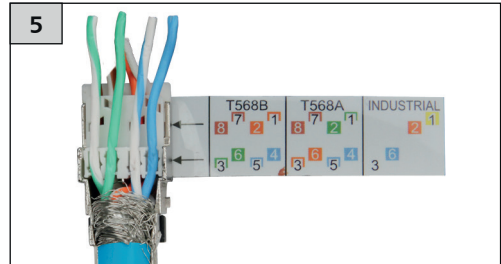
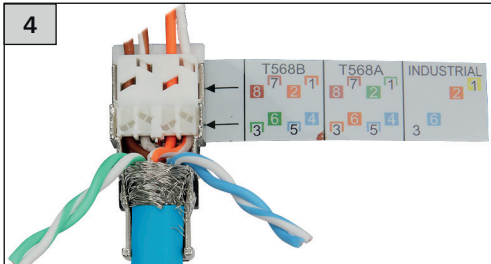
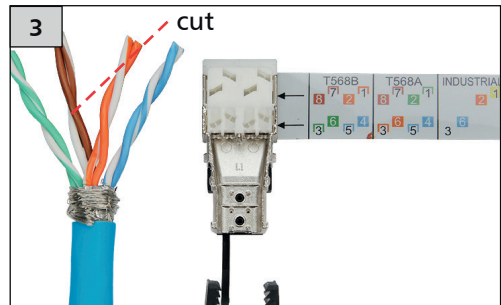

KRAMER ELECTRONICS, Ltd.
Address: 3 Am VeOlamo St., Jerusalem, Israel
Tel: +972 732 650200 Fax: +972 2 653 53 69
E-mail: info@kramerel.com Web: www.KramerAV.com



KRAMER

CON-FIELD | AWG 26/1 - 22/1, AWG 27/7 - 22/7 | CAT6A RJ45 Field plug

Mounting note for the installer

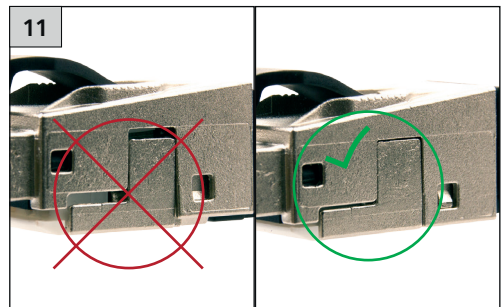
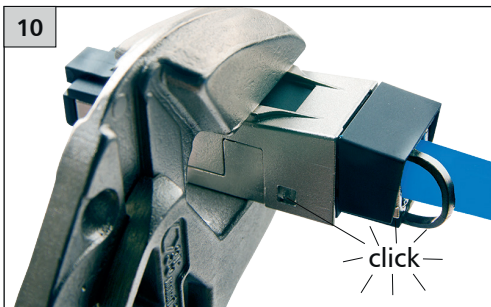
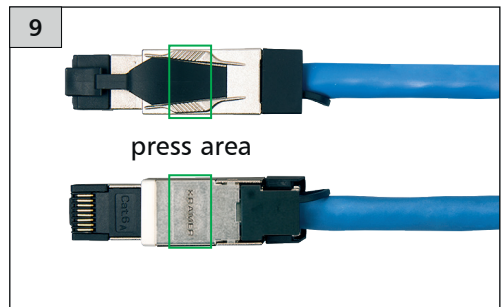
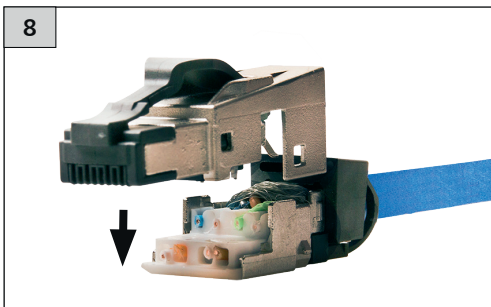
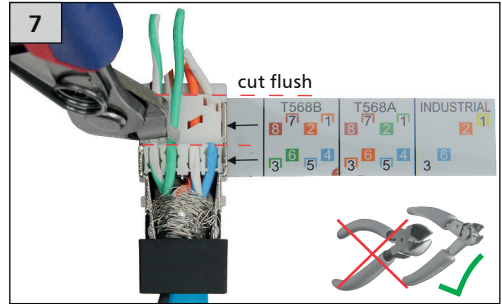
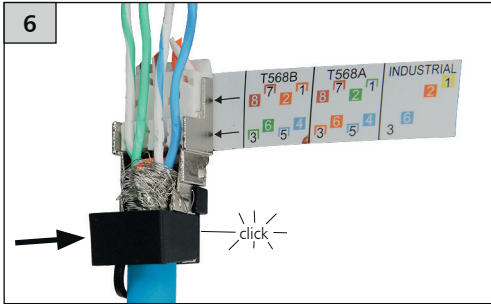

Disassembly

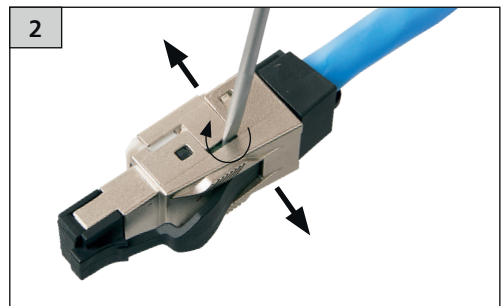
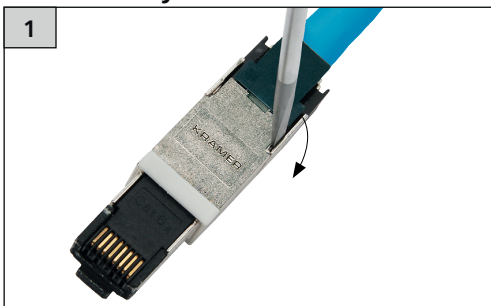

KRAMER ELECTRONICS, Ltd.
 Address: 3 Am VeOlamo St., Jerusalem, Israel
 Tel: +972 732 650200 Fax: +972 2 653 53 69
 E-mail: info@kramerel.com Web: www.KramerAV.com